

# Site Plan of Lot 5, Section 44, Victoria District, Plan 8088

Address : 3767 Waring Place, Victoria

Subject to charges, legal notations, and interests shown on:  
Title No. CB2013865 (P.I.D 000-068-683)

Saanich zoning: RS-12A

Scale 1:150

The intended plot size of this plan is 560mm in width by 432mm in height, C size, when plotted at a scale of 1:150.

Distances and elevations are in metres unless noted otherwise.

## LEGEND

- --- Denotes Iron Post Found
- △ --- Denotes Traverse Station Set
- --- Denotes Utility Pole
- ⊕ --- Denotes Hydrant
- Ⓜ --- Denotes Manhole
- Ⓢ --- Denotes Sewer Service
- Ⓦ --- Denotes Water Service
- ⊖ --- Denotes Utility Pole Anchor

- x 3.94 --- Denotes Typical Spot Elevation
- ★ --- Denotes Coniferous Tree

## Typical Tree Description

- ★ Pine (Species) 0.40 (Trunk Diameter)

- CL - Denotes Centreline
- Conc. - Denotes Concrete
- Dia - Denotes Diameter
- Elev. - Denotes Elevation
- NF - Denotes Nothing Found

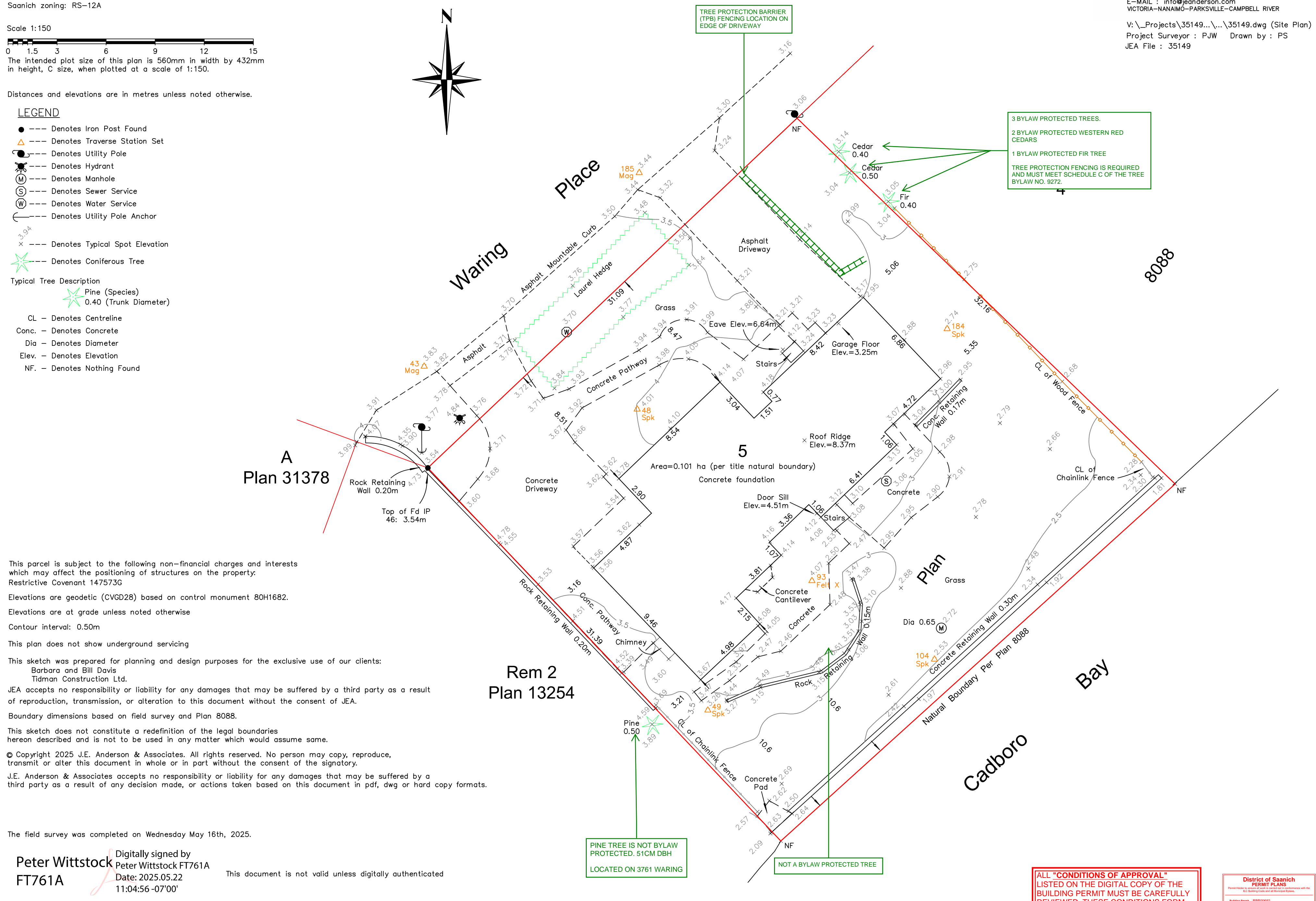
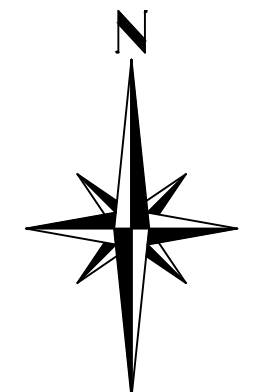

This parcel is subject to the following non-financial charges and interests which may affect the positioning of structures on the property:  
Restrictive Covenant 147573G

Elevations are geodetic (CVGD28) based on control monument 80H1682.

Elevations are at grade unless noted otherwise

Contour interval: 0.50m

This plan does not show underground servicing

This sketch was prepared for planning and design purposes for the exclusive use of our clients:  
Barbara and Bill Davis  
Tidman Construction Ltd.

JEA accepts no responsibility or liability for any damages that may be suffered by a third party as a result of reproduction, transmission, or alteration to this document without the consent of JEA.

Boundary dimensions based on field survey and Plan 8088.

This sketch does not constitute a redefinition of the legal boundaries hereon described and is not to be used in any matter which would assume same.

© Copyright 2025 J.E. Anderson & Associates. All rights reserved. No person may copy, reproduce, transmit or alter this document in whole or in part without the consent of the signatory.

J.E. Anderson & Associates accepts no responsibility or liability for any damages that may be suffered by a third party as a result of any decision made, or actions taken based on this document in pdf, dwg or hard copy formats.

The field survey was completed on Wednesday May 16th, 2025.

**Peter Wittstock** FT761A  
Digitally signed by Peter Wittstock FT761A  
Date: 2025.05.22 11:04:56 -07'00'

This document is not valid unless digitally authenticated

Certified correct this 22nd day of May, 2025.

**ALL "CONDITIONS OF APPROVAL" LISTED ON THE DIGITAL COPY OF THE BUILDING PERMIT MUST BE CAREFULLY REVIEWED. THESE CONDITIONS FORM PART OF THE BUILDING PERMIT.**

District of Saanich  
PERMIT PLANS  
Building Permit: RBP00002  
Date: 5/22/2025  
Inspection Services: APPROVED